

**TOPDON®**

# PulseQ

## AC Portable



**AC EV Charger**

User Manual



# CONTENTS

Section 1 Important Safety Information .....	4
Section 2 What's in the Box .....	6
Section 3 Product Overview .....	7
Section 4 Technical Specifications .....	10
Section 5 How to Charge an EV .....	11
Section 6 Fault Handling .....	16
Section 7 Warranty .....	17

# Section 1

## Important Safety Information

Thank you for purchasing TOPDON's PulseQ AC Portable electric vehicle (EV) charger. To properly use this product, please read this user manual carefully before operating.

### 1.1 Safety Signs



#### CAUTION

This sign indicates that not following proper operations may cause minor to moderate injury to the operator or damage to the product or vehicle. Be sure to adhere to the following instructions.

- Do not submerge the control box in water.
- Do not step on, pull, fold, or knot the cable.
- Do not drop or place any heavy objects on the control box.
- Do not place the cable near high temperature objects or under direct sunlight when charging.
- Do not operate the device in temperatures outside of its designated operating range.
- Put on the dust cover when the product is not in use.
- Use this product in a well-ventilated area.
- The product is not equipped with any user-serviceable parts. Do not try to repair or maintain the product on your own.



#### WARNING

This sign indicates that not following proper operations may cause serious injury to the operator or damage to the device or vehicle. Be sure to adhere to the following instructions.

- This product can only be used when there is a residual current device (RCD) breaker in the power supply section.
- Do not use this product if the cable is damaged.
- This product is only to be used for EV charging.

- The product must be grounded.
- Do not use this product with an extension cord.
- If the product does not operate as described in the user manual, refrain from using it and contact your dealer for repair or replacement.

## **1.2 Safety Precautions**

Ensure that the cable, power input plug, charging connector, and control box are free of any abnormalities, such as scratches, rust, cracks, or any other damage that may affect its proper functioning.

Electric vehicles can only be charged when the engine (motor) is off and the vehicle is stationary. Do not charge in rainy and / or thunderous weather.

Do not charge if your power outlet is damaged, rusted, cracked, or loosely connected.

Wipe with a clean and dry cloth if the power input plug gets dirty or wet.

Ensure that the power input plug and your power outlet are compatible with each other before charging.

# Section 2 What's in the Box

Thank you for purchasing TOPDON's PulseQ AC Portable electric vehicle (EV) charger. To properly use this product, please read this user manual carefully before operating.

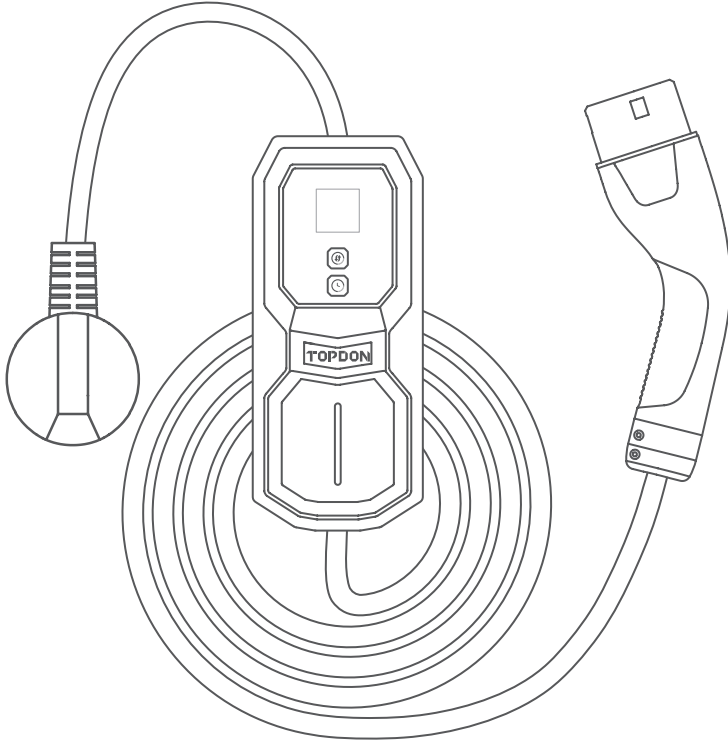

AC Portable EV Charger



User Manual



Carrying Bag

# Section 3 Product Overview

## 3.1 Physical Features

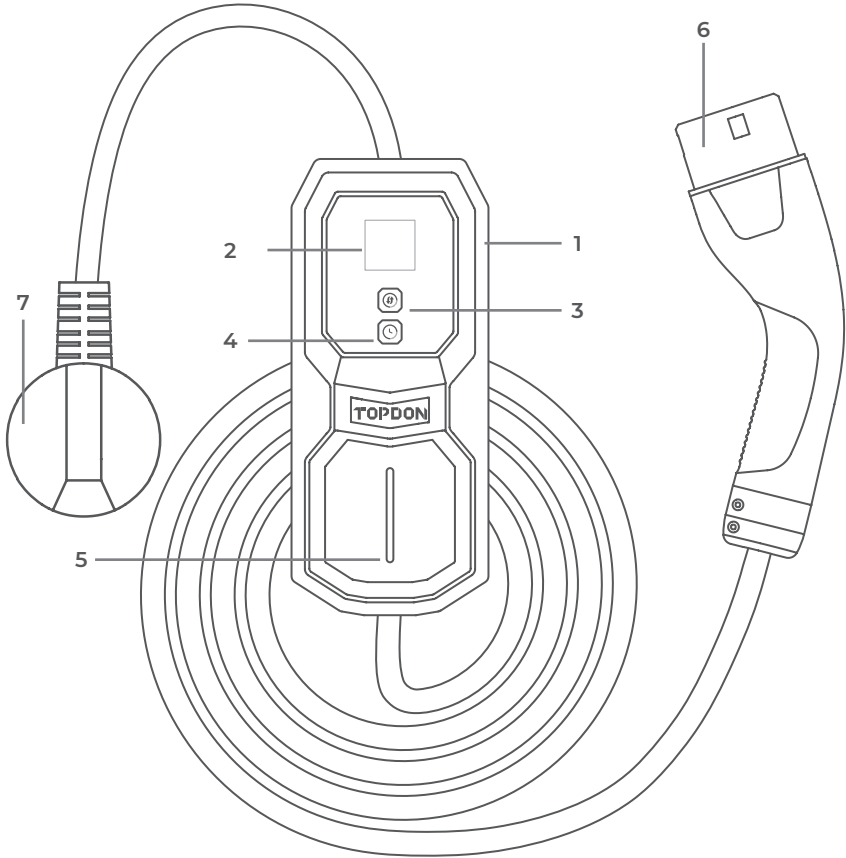

**1. Control Box**

**2. LCD Display**

Displays real-time charging data.

**3. Current Adjust Button**

Allows you to select from the four current options (16/13/10/8A).

#### 4. Charging Schedule Button

Allows you to set the delay time for charging.

#### 5. Charging Status Indicator

Charging Status Indicator	Connotation
Solid green	Standby
Solid blue	Charging connector inserted, ready to charge / Charging complete (connector still inserted)
Flashing blue	Charging in progress
Solid / flashing yellow	Fault (refer to Section 6 for more details)

#### 6. Charging Connector

Connects your PulseQ AC Portable to the inlet socket of your electric vehicle.



#### 7. Power / Charging Input Plug

Connects your PulseQ AC Portable to a power outlet.



EU Plug



UK Plug



AU Plug



## 3.2 LCD Display

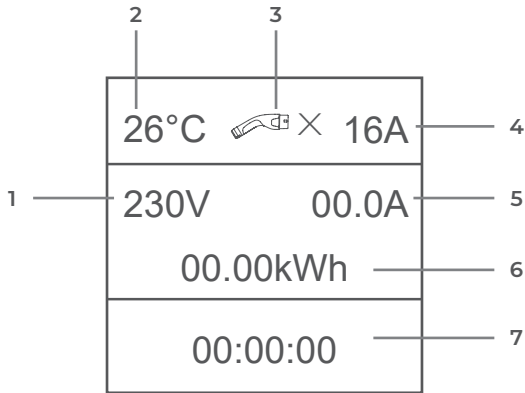

**1. Real-Time Charging Voltage**

**2. Control Box Temperature**

**3. Charging Status Icon**



**4. Selected Charging Current**

**5. Real-Time Charging Current**

**6. Energy Delivered**

**7. Scheduled Charging Countdown / Charging Time**

# Section 4 Technical Specifications

Model Name	PulseQ AC Portable_3.7K_ C5_EU	PulseQ AC Portable_3.7K_ C5_UK	PulseQ AC Portable_3.7K_ C5_AU
Safety Standard	EN 62752		
Charging Mode & Connection	Mode 2, Case C		
Charging Connector Type	IEC 62196-2, Type 2		
Power / Charging Input Plug Type	EU Plug	UK Plug	AU Plug
Rated Current	16A	13A	16A
Rated Voltage	Single-phase 230V AC, 50 / 60Hz		
Total Length	5 m (16.4 ft.)		
Protection Grade (Control Box)	IP 65		
Operating Temperature	-25°C to 45°C		
Storage Temperature	-40°C to 70°C		
Operating Humidity	5%~95% RH (non-condensing)		
Operating Altitude	< 2000 m (6,561.7 ft.)		
Dimensions (Control Box) (L x W x H)	240 x 104 x 63 mm		
Net Weight (Whole Product)	3.21 kg		

# Section 5 How to Charge an EV

The PulseQ AC Portable EV charger offers two charging modes: "Plug and Play" and "Scheduled Charging" modes.

**Note:**



For both charging modes, the charging connector will be locked during the charging process which prevents you from removing it while charging. If you want to stop charging midway, please stop the charging process via the vehicle end.

## Plug & Play

1. Insert the power / charging input plug of the PulseQ AC Portable into the power outlet.

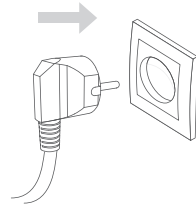

2. Tap the Current Adjust button to select the appropriate current.

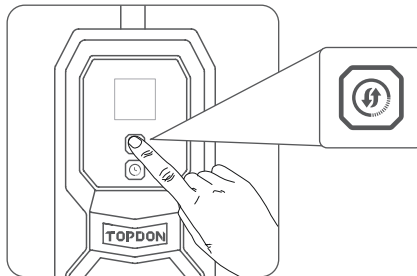

**Note:**



- 1) The current can only be selected prior to inserting the charging connector.
- 2) Please ensure that the selected current is within the carrying capacity of your electrical circuit.

- 3.** Insert the charging connector into the inlet socket of your electric vehicle. Then charging will start automatically.

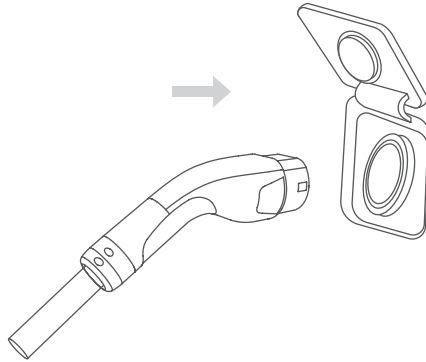

- 4.** Remove the charging connector from the vehicle inlet socket when charging is finished, then disconnect the power / charging input plug from the power outlet.

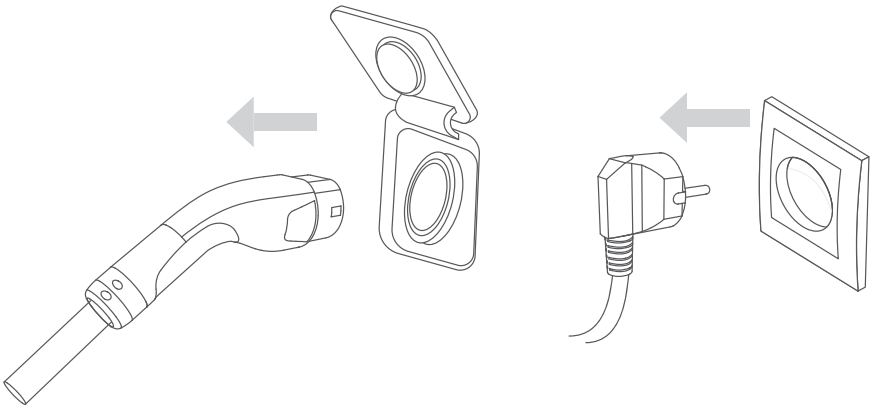

- 5.** Place the dust cover onto the charging connector after use.

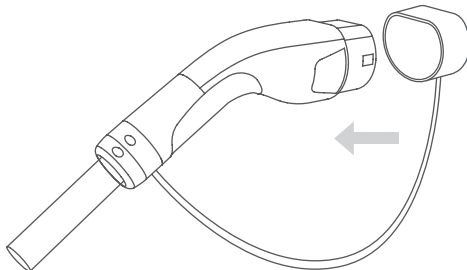

# Scheduled Charging

1. Insert the power / charging input plug of the PulseQ AC Portable into the power outlet.

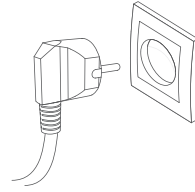

2. Tap the Current Adjust button to select an appropriate current.

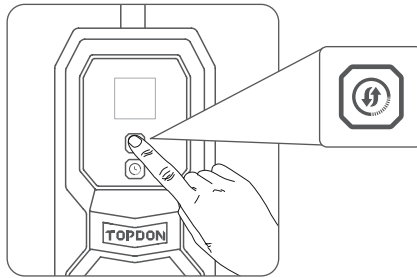

**Note:**



- 1) The current can only be selected prior to inserting the charging connector.
- 2) Please ensure that the selected current is within the carrying capacity of your electrical circuit.

3. Tap the Charging Schedule button to set the desired delay time for charging, up to a maximum of 10 hours. The LCD screen will show a countdown for the scheduled charging after you have set the delay time.

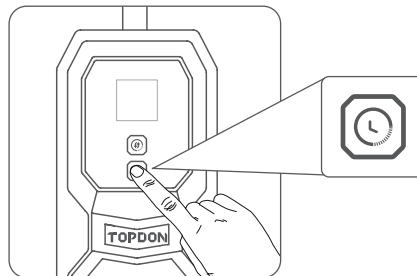

**Note:**



- The charging schedule can only be configured prior to inserting the charging connector.

4. Promptly insert the charging connector when the countdown begins. If you fail to do so before the countdown ends, the charging appointment will not be executed.
5. Charging will start when the countdown concludes.

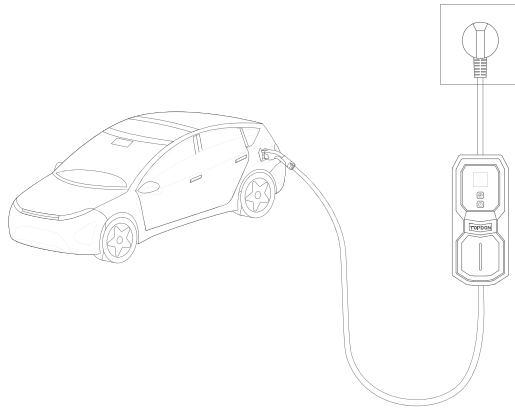

6. Remove the charging connector from the vehicle inlet socket when charging is finished, then disconnect the power / charging input plug from the power outlet.

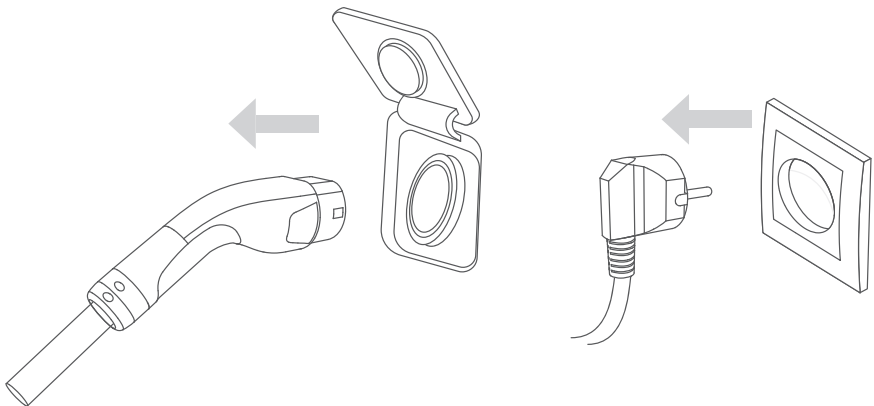

7. Place the dust cover onto the charging connector after use.

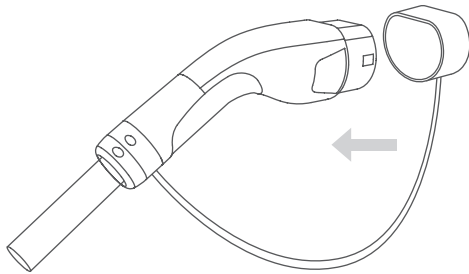

# Section 6 Fault Handling

Fault Description	Possible Cause	Suggestion
Solid yellow	CP fault	Check whether the charging connector is in place. Try unplugging the power input plug and plugging it in again to see whether the fault resolves.
1 yellow blink every second	Overvoltage or undervoltage	Check for any over/under voltage in the input voltage. Try moving the EV charger to a location with stable voltage.
1 yellow blink every 2 seconds	No ground wire	Check whether the ground wire is firmly connected. Try unplugging the power input plug and plugging it in again to see whether the fault resolves.
1 yellow blink every 4 seconds	Overcurrent	Check whether the selected charging current is appropriate. Try unplugging the power input plug and plugging it in again to see whether the fault resolves.
Alternating blue and yellow blinks with a 1s interval between each blink	Electrical leakage	Check for any electrical leaks in the electric vehicle. Try unplugging the power input plug and plugging it in again to see whether the fault resolves.
Alternating blue and yellow blinks with a 2s interval between each blink	Overtemperature	Relocate the EV charger to a cooler environment.



# Section 7 Warranty

## TOPDON One Year Limited Warranty

TOPDON warrants to its original purchaser that the company's products will be free from defects in material and workmanship for 12 months from the date of purchase (Warranty Period).

For the defects reported during the Warranty Period, TOPDON will either repair or replace the defective part or product according to its technical support analysis and confirmation.

TOPDON shall not be liable for any incidental or consequential damages arising from the device's use, misuse, or mounting.

If there is any conflict between the TOPDON warranty policy and local laws, the local laws shall prevail.

This limited warranty is void under the following conditions:

- Misused, disassembled, altered or repaired by unauthorized stores or technicians.
- Careless handling and/or improper operation.

### **Notice:**

All information in this manual is based on the latest information available at the time of publication and no warranty can be made for its accuracy or completeness. TOPDON reserves the right to make changes at any time without notice.





TEL

**86-755-21612590**  
**1-833-629-4832 (NORTH AMERICA)**



EMAIL

**SUPPORT@TOPDON.COM**



WEBSITE

**WWW.TOPDON.COM**



FACEBOOK

**@TOPDONOFFICIAL**



TWITTER

**@TOPDONOFFICIAL**



**RoHS**

